

# EXERCISE 3, THE ABSTRACT

Forest Donovan

Bowen Li

Justin Tsang

Polina Vorobyeva

Osborn Zou

Team 10

# DECISION-MAKING IN OUR INTERVENTION

This documentation is to improve our assigned area of South Berkeley and people's relationships within:

- We first have the “is” condition, which means the existing facilities and environment there.
- Then we point out the potential problems in this area and seek for examples all over the world and improvement plans. We mainly focus on the rooftop of Berkeley Bowl, the Walgreens building, and the idle space on the left of the Walgreens.
- Lastly, we evaluate and compare our plans together for an optimal combination.
- The final decision is to add a rooftop garden on the Berkeley Bowl, expand the scale of Walgreens building, and put the empty space on the road into use. We hope these changes can bring more happiness and convenience to people living in this area.

# OBSERVING THE "IS" CONDITION

1. Parking Congestion
2. Lack of Integration between natural and built environment
3. No Green energy sources
4. No Outside seating areas
5. Walgreens is underutilized
6. Gaps in median is unused on the main street
7. Poor Implementation of infrastructure

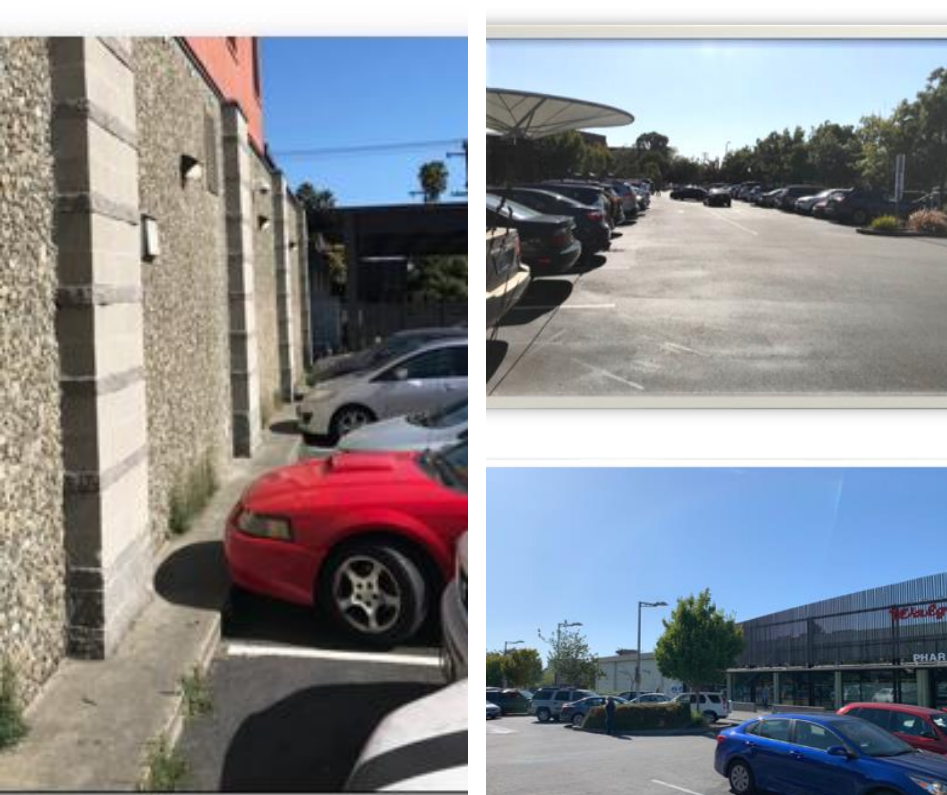



# BERKELEY BOWL: THE ROOFTOP GARDEN

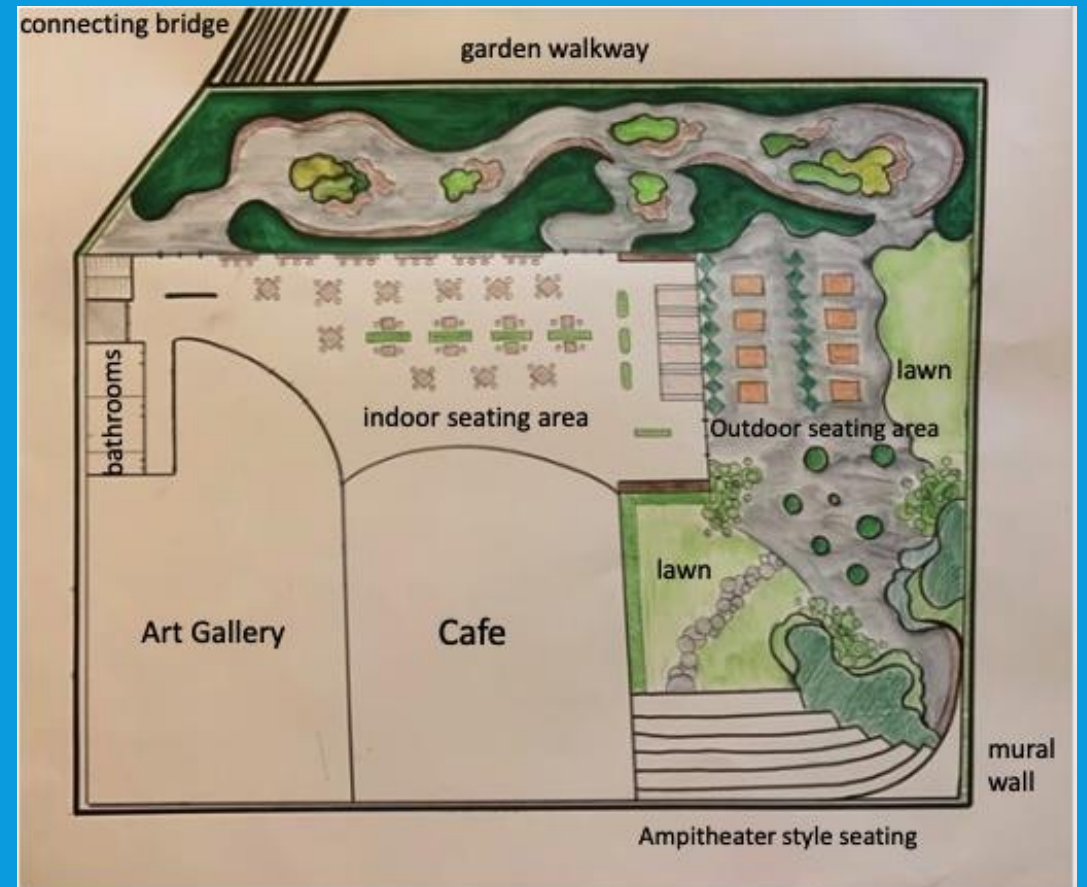
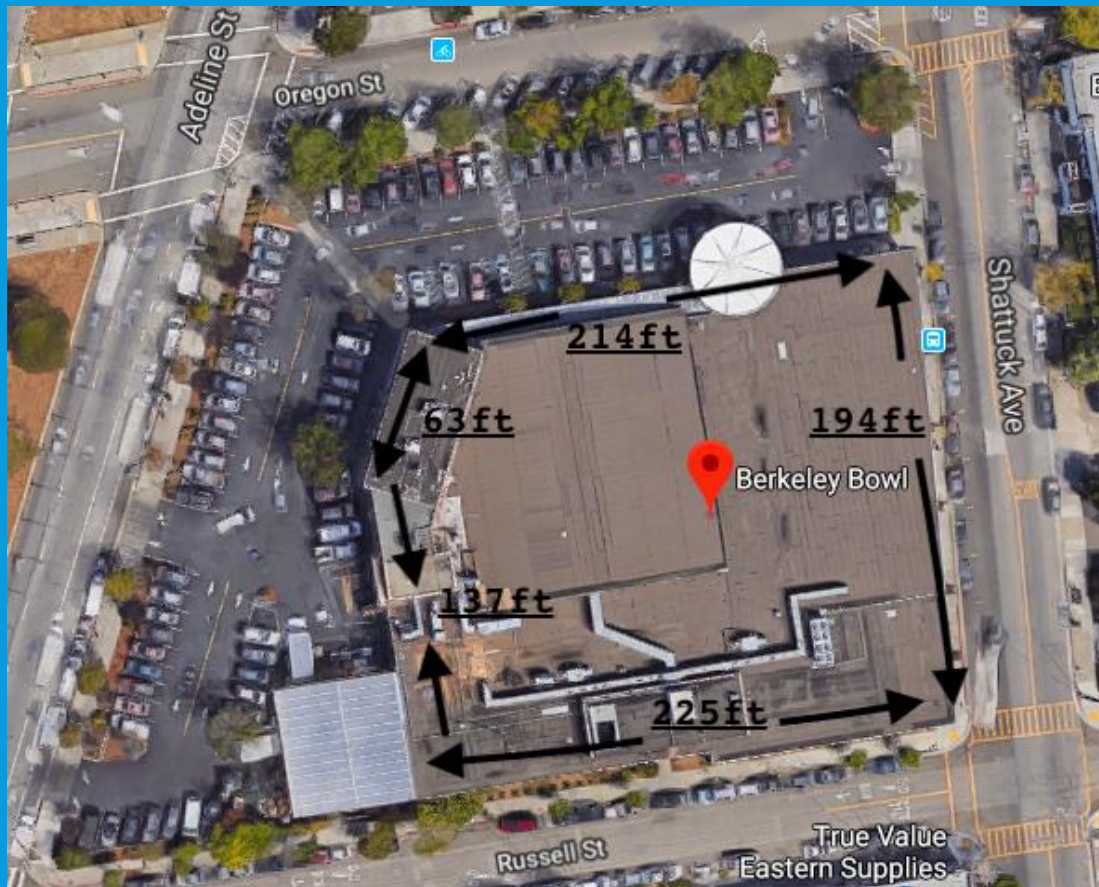

# OUR INTERVENTION:

## Cafe

- Although Berkeley Bowl does have food options, we want to create a greater variety in order to accommodate for the high demand

## Community art gallery

- Not only do we want to create an art gallery to heighten community engagement but we also want to incorporate murals throughout the garden (murals on walls and decorated pots)
- We specifically want Youth Spirit Artworks to work on the murals (keeping the artwork community based)

## Seating area

- We wanted to create a space where people can not only eat but can meet with friends and family to just hang out (both indoor and out)

## Plants

- Rooftop gardens cool the building by guarding it against daily direct sunshine and lower general temperatures of cities affected by hot air pockets as well as low air quality, and pollution.
- We want to surround the walls with vertical gardens and include as much greenery as possible
- This includes both potted plants and directly incorporating plants into the walls

# WALGREENS: NEW BUILDING

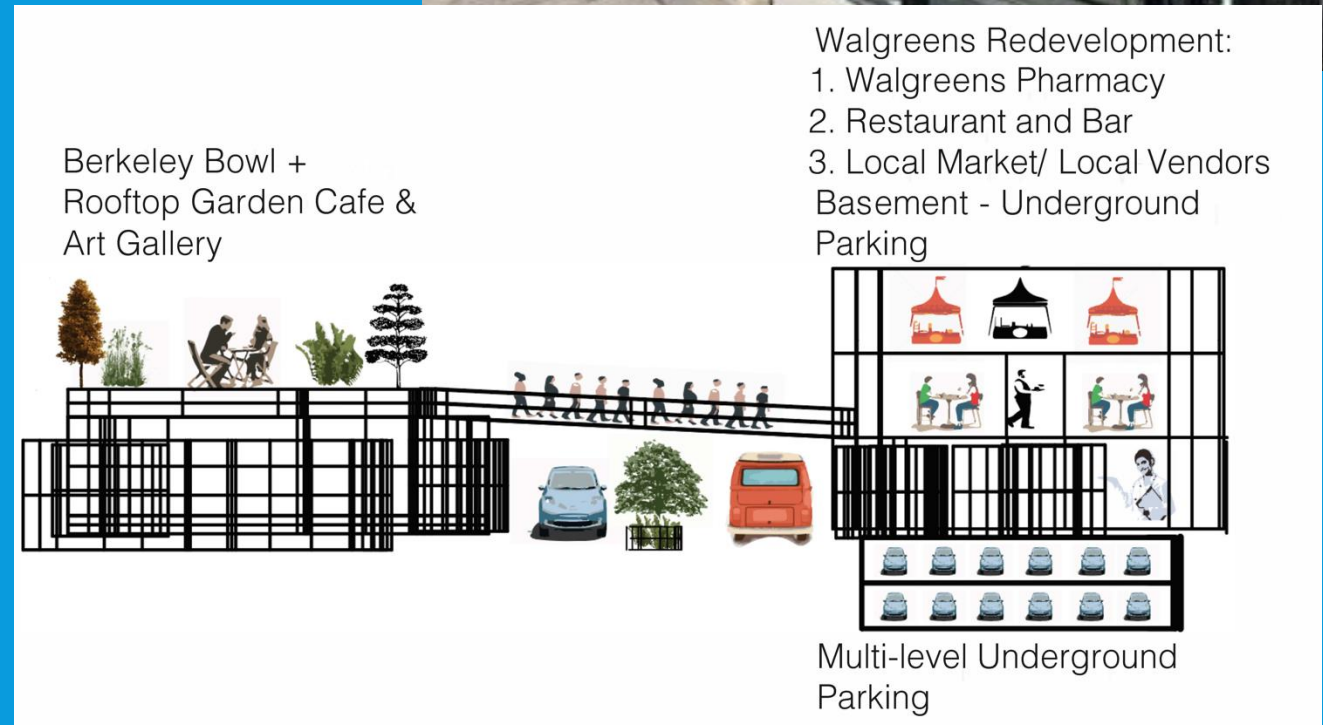



# OUR INTERVENTION:

- **A 3 story shopping plaza**
  - Ground Floor: Redevelop half of Walgreen's space into an entrance for an underground parking garage. The underground parking garage will have plentiful EV charging stations and elevator access.
    - We felt that an added underground parking garage would enhance the overall experience and improve traffic flow.
  - 2nd floor: Local food eateries, a bar, and a music performance area are offered. Connecting glass bridge with 2nd floor of the Walgreens building to the added rooftop garden at Berkeley Bowl.
    - We desired that this space enables people to relax, have fun, and enjoy new experiences.
  - 3rd floor: Local shops and public spaces that allow flexibility for work use and casual conversations.
    - We intended to use this dynamic space for bringing local businesses to share creativity in their offerings.

**⑩ With these additions to the Walgreens redevelopment, we wanted opportunities for new experiences and tastes will bring people and community together.**

# ROADSIDE PARK: ADELINE STREET





# OUR INTERVENTION

- We first plan to expand the idle land to the right side by one vehicle lane. Then, we are going to inhibit cars parking on the lane on the rightmost to make up space for vehicles. Since the traffic is not heavy there, two lanes should promise the traffic fluidity.
- Lastly, we tend to divide the area into half and half: 50% percent or more of the area would be a green plantation, and the other half would be grassland with a coffee shop and seats. For security purpose, wooden fences will be erected around the space.
- The main design purpose is to put this idle space on the left of Walgreens into use. The idea comes from Greeley Park in New York City, which is located in the middle of the avenue.

# CONCLUSION

- With our proposed changes, we were aiming to create more places where people can come together. After studying and being in our neighborhood, we noticed that its prominent aspects are not well integrated into one cohesive environment.
- We chose the Berkeley Bowl/Walgreens plaza because it attracts many people but can be used for so much more than just a great place to buy groceries. The two stores, even though they are so close to each other, seem like two very separate entities.
- We wanted to create a better sense of the community by physically connecting the two main parts of the plaza. Art is an excellent tool for bringing people together, and by creating a space where art can be seen and shared such as the gallery on the rooftop garden, murals, and performance area on the second floor of the new Walgreens area, it will all serve to share the lived experiences with the people around us.
- The third floor of the new Walgreens will also be creating a community by providing a space where local people can support many small local businesses while getting everything they need. Taking into account climate change and how it affects us, we wanted to make sure we keep in mind sustainability and being eco-friendly by incorporating solar panels, EV charging stations, and the rooftop garden with its local and sustainable plant species.
- Finally, the eateries, cafes, garden and roadside park in the proposed plan will serve as a meeting spot for people all over Berkeley and enable people to experience the joy of each other's company while eating. An environment can tell a lot about the people who dwell in it, and we think that it is vital to show just how welcoming Berkeley can be by creating spaces for that to happen.